



DOCUMENTATION SHEET

Anti-vibration Mountings  
Type MP1

# MP 1

### General

The MP-mountings (Multi Purpose) are developed to offer excellent passive and active vibration isolation for various applications. Next to offering excellent isolation the MP-mountings internal deflection limiter avoids overload and allows use for mobile applications on for example trucks and on board of ships. The geometry of the metal top offers protection to the natural rubber against oil and ozone.

Typical applications:

- Generators
- Engines
- Fans
- AC-units
- Cooling equipment
- Electro motors
- Cabinets

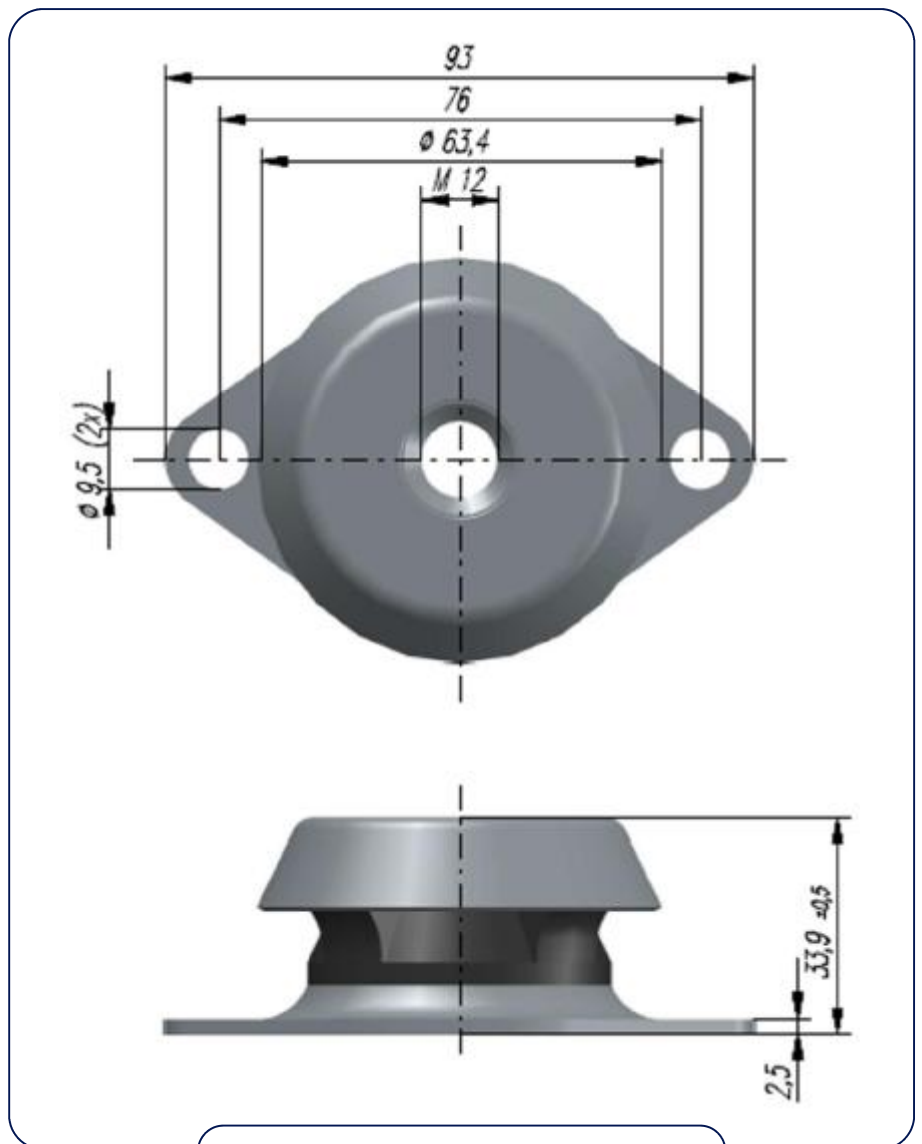

Dimensions





Type	Max. load marine (N)	Max. load static (N)	Max. vert. defl. marine (mm)	Max. vert. defl. static (mm)	Cz stiffness (N/mm)
MP1-45	350	400	4	4.4	100
MP1-60	500	565	3.8	4.2	160

### CHARACTERISTICS

Vertical Load / deflection Characteristics  
Type MP-1

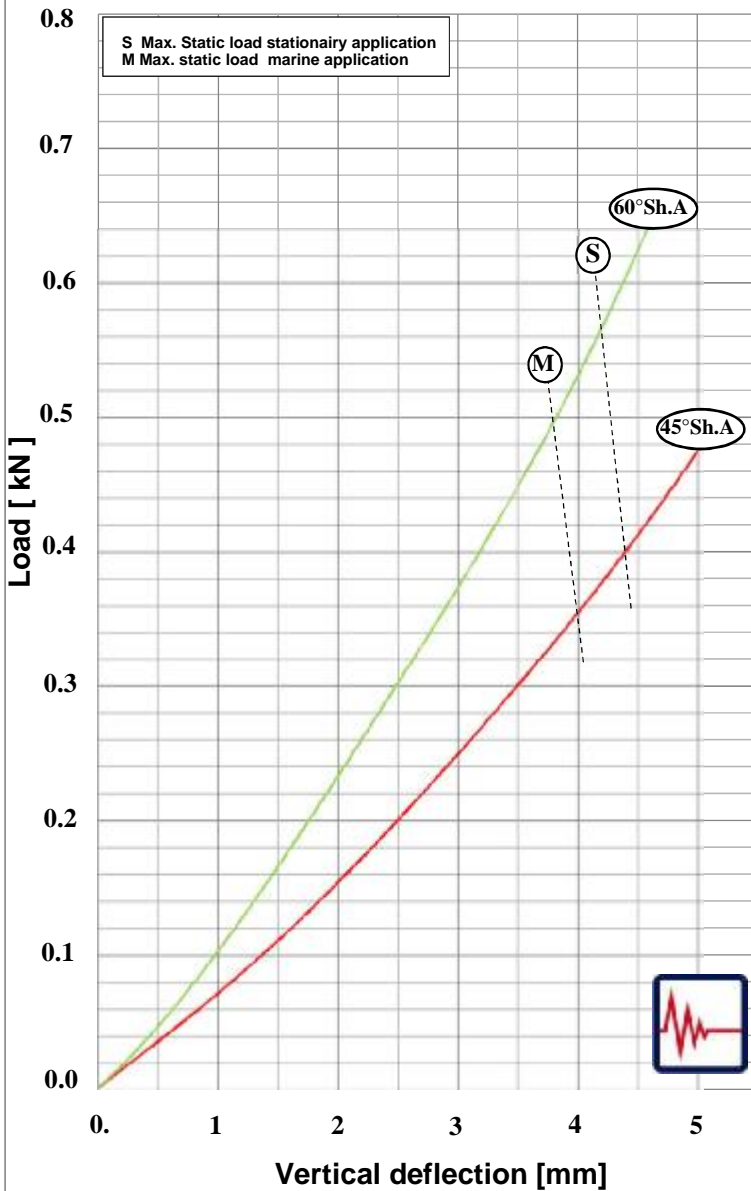

### SELECTION CURVE

# MP 1



Rubber Design B.V.  
Industrieweg 21  
2995BE Heerjansdam  
The Netherlands  
Phone: +31 (0) 78 677 87 78  
Fax: +31 (0) 78 677 10 38  
Email: [info@rubberdesign.nl](mailto:info@rubberdesign.nl)  
Web: [www.rubberdesign.nl](http://www.rubberdesign.nl)